

Inductive sensors

IFW200

IFK3003BBPKG/K1/SC/M/US
 Inductive sensor
 Metal thread M12 x 1
 Connector
 Electromagnetic-field immune
 Increased sensing range
 gold-plated contacts
 Correction factor = 1

Sensing range 3 mm [f]
 flush mountable

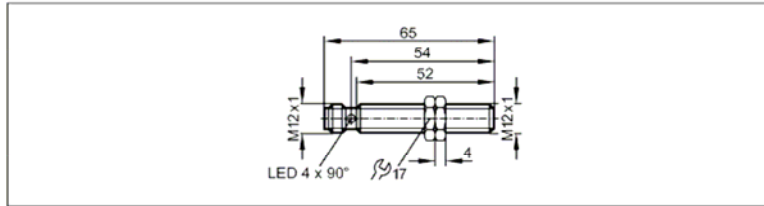

Made in Germany

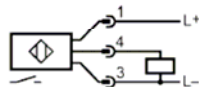

Electrical design	DC PNP
Output	normally open
Operating voltage [V]	10...30 DC
Current rating [mA]	200
Short-circuit protection	pulsed
Reverse polarity protection	yes
Overload protection	yes
Voltage drop [V]	< 2.5
Current consumption [mA]	< 20
Real sensing range [mm]	3 ± 10 %
Operating distance [mm]	0...2.4
Switch-point drift [% of Sr]	-10...10
Hysteresis [% of Sr]	3...15
Switching frequency [Hz]	4000
Correction factors	mild steel = 1 / stainless steel approx. 1 / brass approx. 1 / Al approx. 1 / Cu approx. 1
Ambient temperature [°C]	-25...70
Protection	IP 67, II
EMC	EN 61000-4-2 ESD: 4 kV CD / 8 kV AD EN 61000-4-3 HF radiated: 10 V/m (80...1000 MHz) EN 61000-4-4 Burst: 2 kV EN 61000-4-6 HF conducted: 10 V (0.15...80 MHz) EN 55011: class B
Housing materials	housing: brass safe-coated; active face: Duroplast (PF)
Function display	
Switching status LED	yellow (4 x 90°)
Connection	M12 connector; gold-plated contacts
Weight [kg]	0.037
Remarks	cULus - Class 2 source required
Accessories (included)	2 lock nuts

Wiring

Courtenay House, Monument Way East, Woking,
 Surrey GU21 5LY, United Kingdom

Tel: +44(0)844 443 7925
 Fax: +44(0)844 443 7928

Web Site: www.medcotas.com